

STAVAL

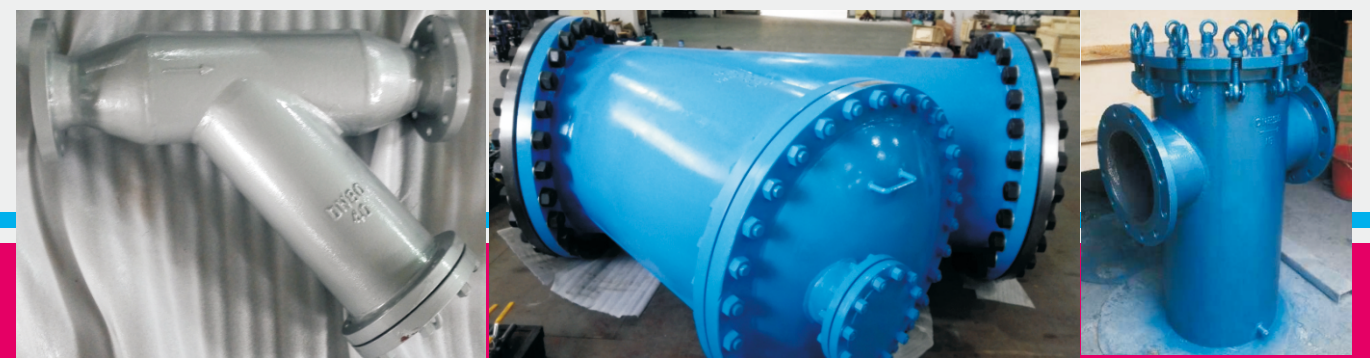

厦门斯嘉达阀门科技有限公司
XIAMEN STAVAL VALVE TECHNOLOGY.,LTD

Add: No.1006,Builing1,Hubin South Road,Siming District, Xiamen, China
Phone/whatsapp: +86 15759227330
Email: inquiry@stavalves.com
Web: www.stavalves.com



PRODUCT CATALOGUE
XIAMEN STAVAL VALVE TECHNOLOGY CO.,LTD



COMPANY PROFILE

XIAMEN STAVAL VALVE TECHNOLOGY Co., Ltd. Marketing department is located in Xiamen, China, a beautiful garden city with developed economy and convenient transportation, attracting a large number of talents and creating value for world development. And the manufacturing headquarters is located in Wenzhou, the hometown of China pumps and valves.

STAVAL is a valve company providing one-stop solution integrating production, trade and inspection services. We are committed to engineering design, manufacturing and supplying superior products, and providing excellent personal service to our customers. We have a well-established system equipped with a capable team of responsible technicians and inspectors, perfect workshop management and experienced sales department. After years of accumulation, STAVAL has a wide range of business radiation, covering South America, Europe, South Africa, the Middle East, etc, and it's still growing.

STAVAL RPRODUCTS

We provide the best professional solutions for the most demanding industries, including oil and gas, chemical, petrochemical, pharmaceutical and mining. Our products include gate valves, globe valves, check valves, ball valves, butterfly valves, plug valves, strainers and so on, which sizes ranges from 1/2" all the way to 60", pressure from ANSI /ASME 125 to 4500LBS and UNI from PN6 to PN400, and the standard is according to API, ASME, ASTM, EN, DIN, GOST, GB.

STAVAL QUALITY

Outstanding quality is our first priority. STAVAL specially develops a team of experienced technicians and inspectors who have engaged in valve field for more than 10 years to control the production process and quality. From raw material selection to final shipment, we guarantee that the whole process will be under strictly monitoring.What's worthy noted is that we do 100% inspection before shipment. Inspection contents include appearance, dimensions, material chemical compositions, hydraulic test, air test, torque value, painting (type, color, thickness and painting technique), package and so on.

STAVAL ADVANTAGE

Our expertise is to figure out personalized solutions to every customer's unique requirements and provide excellent service with accurate and reasonable prices, outstanding quality and valued technical solution. We hope to be not only your business supplier, but also one part of your team!

What you want is what I want, let our indispensable advantage be your best choice!

1.Y Strainer

Y strainers are a cost-effective solution for the mechanical removal of unwanted impurities from liquid, gas or steam lines by means of a perforated or wire mesh straining element. They are used in pipelines to protect pumps, meters, control valves, steam traps, regulators and other process equipment. A Y-strainer has the advantage of being able to be installed in either a horizontal or vertical position. However, in both cases, the screen element must be on the "downside" of the strainer body so the impurities can be properly collected and held for disposal. Y Strainers are furnished with high quality stainless steel screens that are carefully fabricated to fit the strainer body perfectly.

Features	
Size	1/2"-48"
Pressure Rating	Class150LB~2500LB
Body Material	WCB, LCB, CF8, CF3, CF8M, CF3M, C5, WC6, WC9, W12
Screen Material	SS304,SS316, SS316L, F51, Monel, Hastelloy
Design&Manufacture Standard	ASME B16.34
Face-to-face	ASME B16.10
End Connection	ASME B16.5 ASME B16.47 ASME B16.25 ASME B16.11
Test and Inspection	API 598

● Ansi Cast Y Strainer

CLASS:150LB		CLASS:300LB		CLASS:600LB		CLASS:900LB		CLASS:1500LB	
DN	L	DN	L	DN	L	DN	L	DN	L
1 1/2"	130	1 1/2"	130	1 1/2"	165	3 1/4"	229	1 1/2"	216
3 1/4"	150	3 1/4"	150	3 1/4"	190	1"	254	3 1/4"	229
1"	160	1"	160	1"	216	1 1/4"	279	1"	254
1 1/4"	180	1 1/4"	180	1 1/4"	229	1 1/2"	305	1 1/4"	279
1 1/2"	200	1 1/2"	230	1 1/2"	241	2"	368	1 1/2"	305
2"	203	2"	267	2"	292	2 1/2"	419	2"	368
2 1/2"	216	2 1/2"	292	2 1/2"	330	3"	384	2 1/2"	419
3"	241	3"	318	3"	356	4"	457	3"	470
4"	292	4"	356	4"	432	5"	-	4"	546
5"	356	5"	400	5"	508	6"	610	5"	673
6"	406	6"	444	6"	559	8"	737	6"	705
8"	495	8"	559	8"	660	10"	838	8"	832
10"	622	10"	622	10"	787	12"	965	10"	991
12"	699	12"	711	12"	838	14"	-	12"	1130
14"	787	14"	838	14"	838	16"	1130		
16"	914			16"	1025				
18"	978								
20"	978								
22"	1067								
24"	1295								
32"	1600								

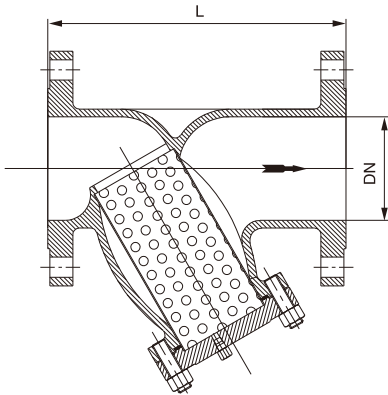

● Din Cast Y Straienr

Features	
Size	DN15~DN800
Pressure Rating	PN10~PN250
Body Material	WCB, LCB, CF8, CF3, CF8M, CF3M, C5, WC6, WC9,W12
Screen Material	SS304,SS316, SS316L, F51, Monel, Hastelloy
Design&Manufacture Standard	EN 13709
Face-to-face	EN 558-1
End Connection	EN 1092-1 EN 12627
Test and Inspection	EN 12266a

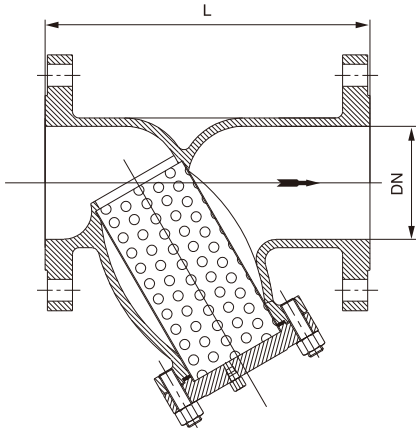

PN:PN16		PN:PN25		PN:PN40	
DN	L	DN	L	DN	L
DN15	130	DN15	130	DN15	130
DN20	150	DN20	150	DN20	150
DN25	160	DN25	160	DN25	160
DN32	180	DN32	180	DN32	180
DN40	200	DN40	200	DN40	200
DN50	230	DN50	230	DN50	230
DN65	290	DN65	290	DN65	290
DN80	310	DN80	310	DN80	310
DN100	350	DN100	350	DN100	350
DN125	400	DN125	400	DN125	400
DN150	480	DN150	480	DN150	480
DN200	600	DN200	600	DN200	600
DN250	730	DN250	730	DN250	730
DN300	850	DN300	850	DN300	850
DN400	980	DN400	980	DN400	980



● Forged Y Strainer

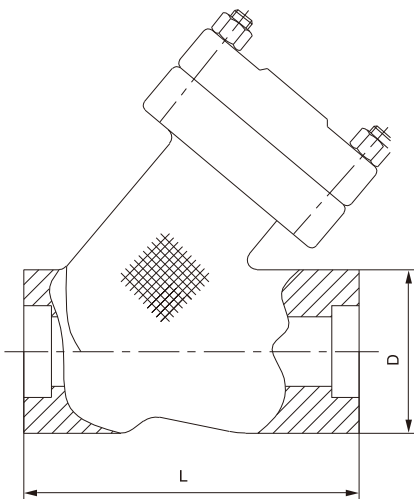

Features	
Size	1/2"-2"
Pressure Rating	800LB 900LB 1500LB 2500LB
Body Material	A105 LF2 F11 F5 F304 F304L F316 F316L
Screen Material	SS304,SS316, SS316L, F51, Monel, Hastelloy
Design&Manufacture Standard	ASME B16.34
Face-to-face	MFG's Standard
End Connection	ASME B16.5 ASME B16.25 ASME B16.11
Test and Inspection	API 598



CLASS	DN	L	D
800LB	2"	170	80
800LB	1 1 /2"	140	65
800LB	1 1 /4"	140	65
800LB	1"	120	50
800LB	3 /4"	100	40
800LB	1 /2"	100	40

● Fabricated Y STRAINER

Features	
Size	2"-40" DN50~DN1000
Pressure Rating	Class150LB~300LB PN10~PN40
Body Material	WPB A106-B A53 B WPL6 TP304 TP316 TP316L
Screen Material	SS304,SS316, SS316L, F51, Monel, Hastelloy
Design&Manufacture Standard	MFG's Standard
Face-to-face	MFG's Standard
End Connection	Flange BW
Test and Inspection	API 598

Fabricated y strainer are unique designs that fit the exact requirement of any application.

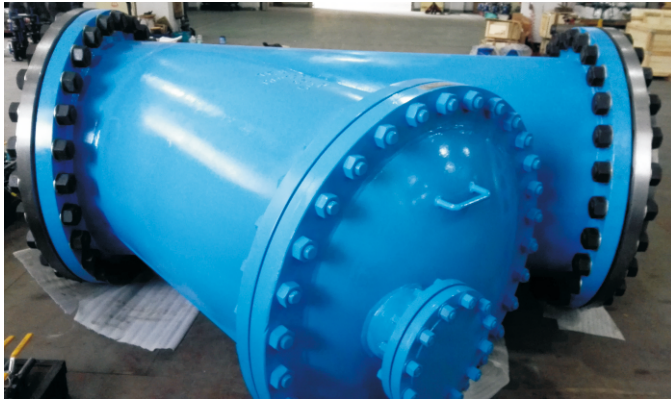

2.Simplex Basket Strainer

Simplex Basket Strainers are used in pipeline applications where requires a strainer with an extremely large capacity. Most of these strainer have an greater open area ratios available than Y-strainer. Simplex Basket Strainer are used to protect pipelines, valves, pumps. They reduce the necessity for frequent cleaning and provides a cost and time saving benefit with less downtime. Simplex Basket Strainers are furnished with high quality stainless steel screens that are carefully fabricated to fit the strainer body perfectly. A basket strainer requires a removal of the screen for cleaning.

Features	
Size	2"-40" DN50~DN1000
Pressure Rating	Class150LB~300LB PN10~PN40
Body Material	WPB A106-B A53 B WPL6 TP304 TP316 TP316L
Screen Material	SS304,SS316, SS316L, F51, Monel, Hastelloy
Design&Manufacture Standard	MFG's Standard
Face-to-face	MFG's Standard
End Connection	Flange BW
Test and Inspection	API 598

● Fabricated Simplex Basket Strainer

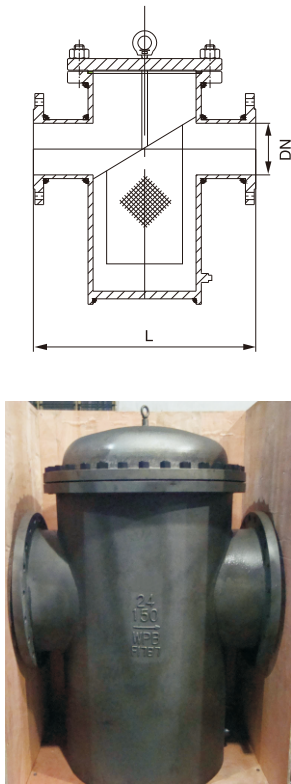

CLASS	DN	L	CLASS	DN	L
150LB	24"	1100	300LB	24"	1100
150LB	20"	1050	300LB	20"	1050
150LB	18"	950	300LB	18"	950
150LB	16"	900	300LB	16"	900
150LB	14"	800	300LB	14"	800
150LB	12"	750	300LB	12"	750
150LB	10"	660	300LB	10"	660
150LB	8"	560	300LB	8"	560
150LB	6"	500	300LB	6"	500
150LB	5"	480	300LB	5"	480
150LB	4"	430	300LB	4"	430
150LB	3"	340	300LB	3"	340
150LB	2 1/2"	330	300LB	2 1/2"	330
150LB	2"	270	300LB	2"	270
150LB	1 1/2"	270	300LB	1 1/2"	270
150LB	1 1/4"	230	300LB	1 1/4"	230
150LB	1"	215	300LB	1"	215

● Cast Simplex Basket Strainer

Features	
Size	2"-40" DN50~DN1000
Pressure Rating	Class150LB~300LB PN10~PN40
Body Material	WCB, LCB, CF8, CF3, CF8M CF3M, C5, WC6, WC9, W12
Screen Material	SS304,SS316, SS316L, F51, Monel, Hastelloy
Design&Manufacture Standard	MFG's Standard
Face-to-face	MFG's Standard
End Connection	Flange BW
Test and Inspection	API 598

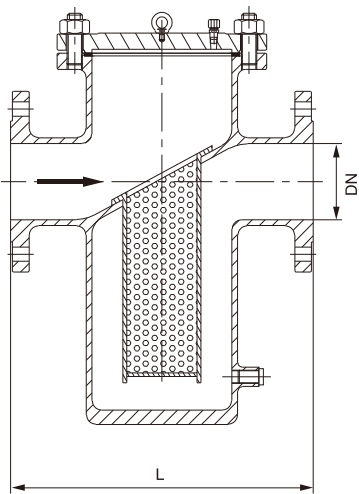

CLASS	NPS	L
150LB	8"	625
150LB	6"	500
150LB	5"	480
150LB	4"	430
150LB	3"	318
150LB	2 1/2"	310
150LB	2"	275
150LB	1 1/2"	275
150LB	1"	250



3.Quick-open Baset Strainer

● Quick-open Basket Strainer

Pipeline equipments are required to be opened frequently for servicing. Precisely for this reason, we have designed, manufactured and supplied various types of quick opening closures to our customersm thereby freeing up our customers resources to pursue more profitable operations.

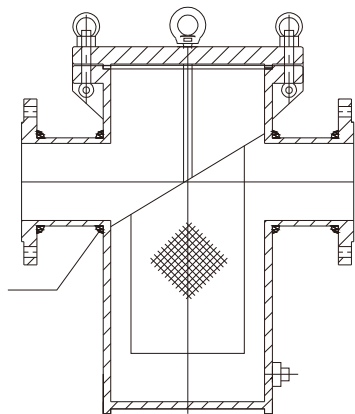

4.Duplex Basket Strainer

Duplex Basket Strainers are designed for use in continuous flow handling systems where the flow cannot be shut down for screen cleaning .It can provide uninterrupted downtime for maintenance and cleaning. Typical applications include :lubrication systems, cooling water,fire lines,fuel lines,chemical process systems,pump suction service and other similar application.

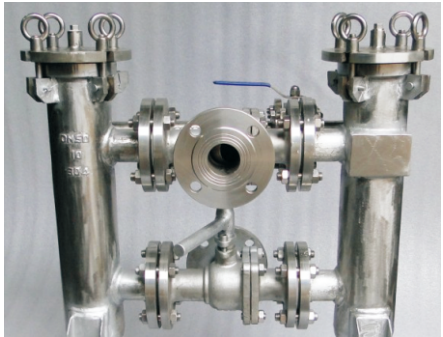

● Fabricated Duplex Basket Strainer

Features	
Size	2"-40" DN50~DN1000
Pressure Rating	Class150LB~300LB PN10~PN40
Body Material	WPB A106-B A53 B WPL6 TP304 TP316 TP316L
Screen Material	SS304,SS316, SS316L, F51, Monel, Hastelloy
Design&Manufacture Standard	MFG's Standard
Face-to-face	MFG's Standard
End Connection	Flange BW
Test and Inspection	API 598

Fabricated Duplex Basket Strainer can operate continuously and features two fabricated Basket Strainers which are installed parallel and connected by valves(ball valve or butterfly valve).

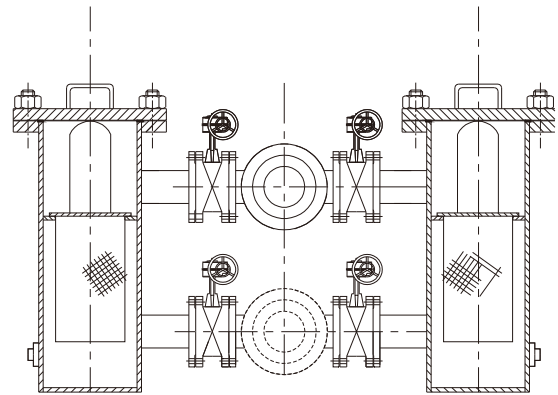
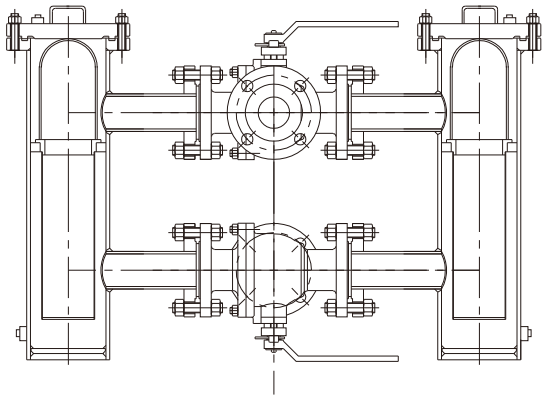

● Cast Duplex Basket Strainer

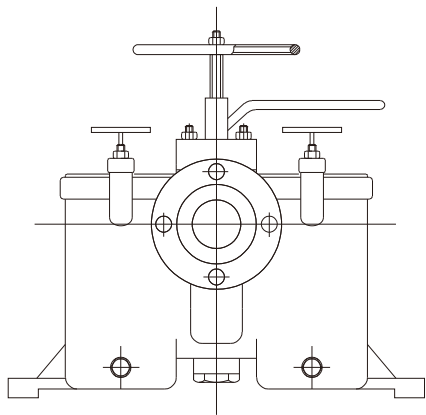

Features	
Size	2"-40" DN50~DN1000
Pressure Rating	Class150LB~300LB PN10~PN40
Body Material	WCB, LCB, CF8, CF3, CF8M, CF3M, C5, WC6, WC9, W12
Screen Material	SS304,SS316, SS316L, F51, Monel, Hastelloy
Design&Manufacture Standard	MFG's Standard
Face-to-face	MFG's Standard
End Connection	Flange BW
Test and Inspection	API 598

5.Tee Strainer

● Tee Strainer

Tee Strainer can be provided in several different orientations for horizontal or vertical installations , it offers versatile design options to fit the needs of customer s application,.

Features	
Size	2"-40" DN50~DN1000
Pressure Rating	Class150LB~300LB PN10~PN40
Body Material	WPB A106-B A53 B WPL6 TP304 TP316 TP316L
Screen Material	SS304,SS316, SS316L, F51, Monel, Hastelloy
Design&Manufacture Standard	MFG's Standard
Face-to-face	MFG's Standard
End Connection	Flange BW
Test and Inspection	API 598

● Fabricated Tee Strainer

DN	L	H
24"	864	575
20"	762	515
18"	686	470
16"	610	420
14"	558	400
12"	508	360
10"	432	310
8"	356	275
6"	286	225
5"	248	205
4"	210	175
3"	172	150
2 1 /2"	152	140
2"	128	120

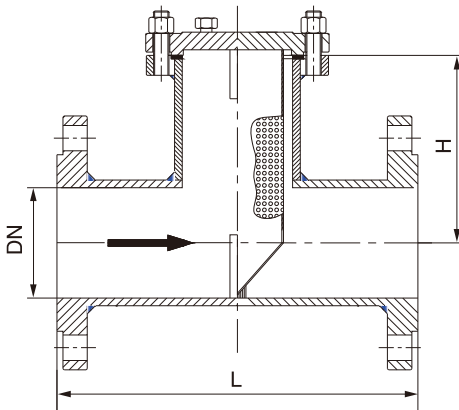
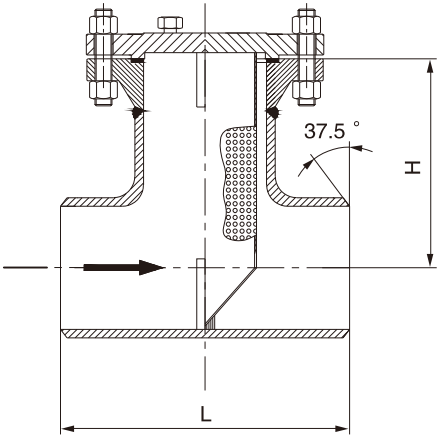

CLASS	DN	L	H
150LB	20"	1050	600
150LB	18"	1000	600
150LB	16"	970	530
150LB	14"	840	460
150LB	12"	735	400
150LB	10"	635	350
150LB	8"	560	310
150LB	6"	465	270
150LB	5"	400	265
150LB	4"	360	265
150LB	3"	310	180
150LB	2 1 /2"	280	160
150LB	2"	250	150

● Cast Tee Strainer

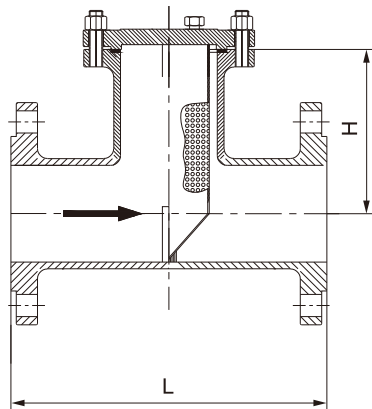

Features	
Size	2"-40" DN50~DN1000
Pressure Rating	Class150LB~300LB PN10~PN40
Body Material	WCB, LCB, CF8, CF3, CF8M, CF3M, C5, WC6, WC9, W12
Screen Material	SS304,SS316, SS316L, F51, Monel, Hastelloy
Design&Manufacture Standard	MFG's Standard
Face-to-face	MFG's Standard
End Connection	Flange BW
Test and Inspection	API 598



CLASS	DN	L	H
150LB	20"	1050	600
150LB	18"	1000	600
150LB	16"	970	530
150LB	14"	840	460
150LB	12"	735	400
150LB	10"	635	350
150LB	8"	560	310
150LB	6"	465	270
150LB	5"	400	265
150LB	4"	360	265
150LB	3"	310	180
150LB	2 1/2"	280	160
150LB	2"	250	150

6.U Strainer

U Strainers are used in pipeline applications where requires a strainer with an extremely large capacity. Most of these strainers are similar to Basket Strainer in shape. But the screen structure is different.

Features	
Size	2"-40" DN50~DN1000
Pressure Rating	Class150LB~300LB PN10~PN40
Body Material	WCB, LCB, CF8, CF3, CF8M, CF3M, C5, WC6, WC9, W12
Screen Material	SS304,SS316, SS316L, F51, Monel, Hastelloy
Design&Manufacture Standard	MFG's Standard
Face-to-face	MFG's Standard
End Connection	Flange BW
Test and Inspection	API 598

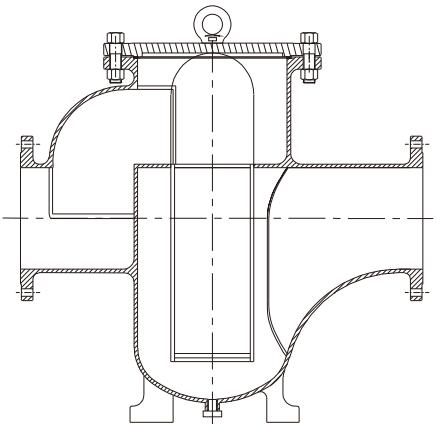

7. Automatic Self-cleaning Strainer



8. Temporary Strainer

Temporary Strainers are designed in cone ,basket,or plate shape. The temporary strainers are a effective mean for temporary straining for start-up applications.Fabricated temporary cone,basket,or plate strainers are designed for initial start-up and should not be used as a Permanent straining solution.

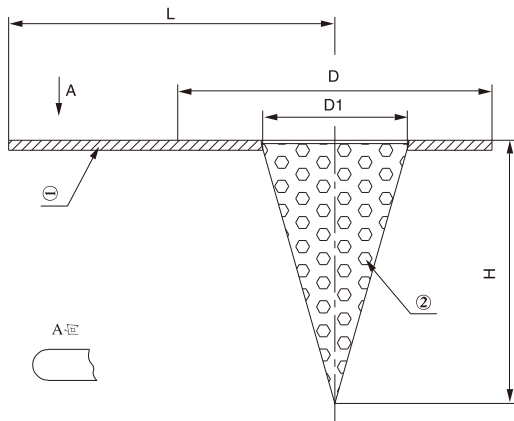

ITEM	SIZE	ANSI	Materials		D	D1	H	L
			①	②				
1	1"	150LB	SS304	SS304	46	20	95	115
2	1 1 /2"	150LB	SS304	SS304	68	35	100	125
3	2"	150LB	SS304	SS304	87	45	115	135
4	3"	150LB	SS304	SS304	122	75	165	155
5	4"	150LB	SS304	SS304	152	95	215	175
6	6"	150LB	SS304	SS304	210	145	300	200
7	8"	150LB	SS304	SS304	265	195	400	235
8	10"	150LB	SS304	SS304	318	245	485	260
9	12"	150LB	SS304	SS304	375	295	585	300
10	14"	150LB	SS304	SS304	408	345	610	330
11	16"	150LB	SS304	SS304	464	395	670	358
12	18"	150LB	SS304	SS304	528	445	750	380

9.Screen

Screen is the heart of strainer,it should be designed to be both effective and durable. We supply basket for simplex and duplex strainers and screens for Y strainers,in standard and heavy-duty design. Standard designed screens meet the needs of most applications. We also can manufacture screens according to customer s special requirements.

